



# FIDI BANKING HALL

# A MANHATAN SUCCESS STORY

---

The vibrancy and style of New York's financial district come together to create a majestic landmark property at Pine Street.

Comprised of 1.3 million square-feet of office space distributed over 72 stories, with six two-story vaults set into the bedrock foundations, this 1930 property was once the tallest building in the world. Originally named the Manhattan Company Building, it is directly across from the New York Stock Exchange, and towers over the city as a reminder of New York's global status.



*Bank of Manhattan Trust, New York*



# FIDI BANKING HALL





























































# FLOOR PLAN

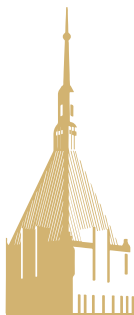
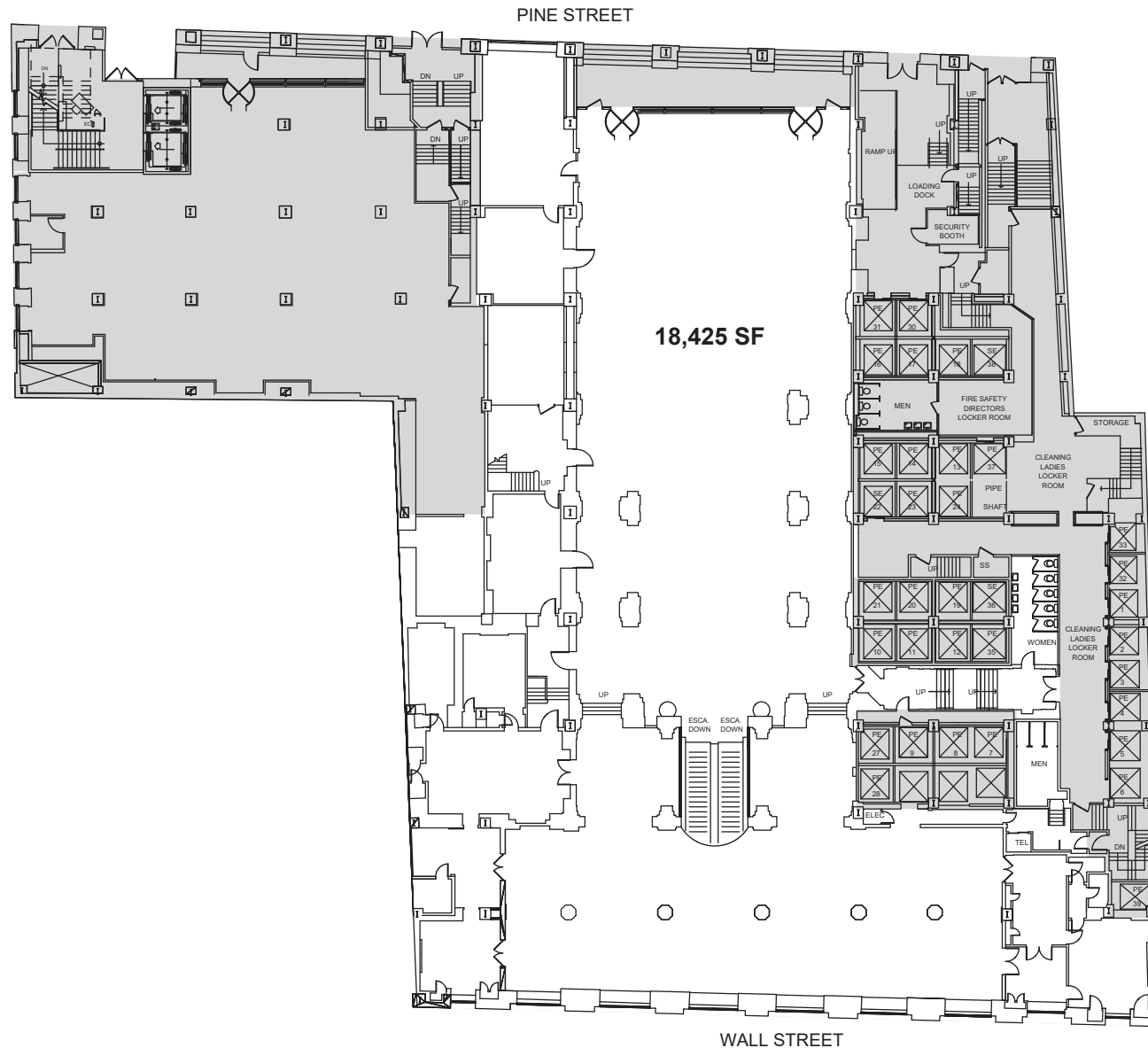

**FIDI**  
BANKING HALL

**Mezzanine - Street Level (Pine St)**



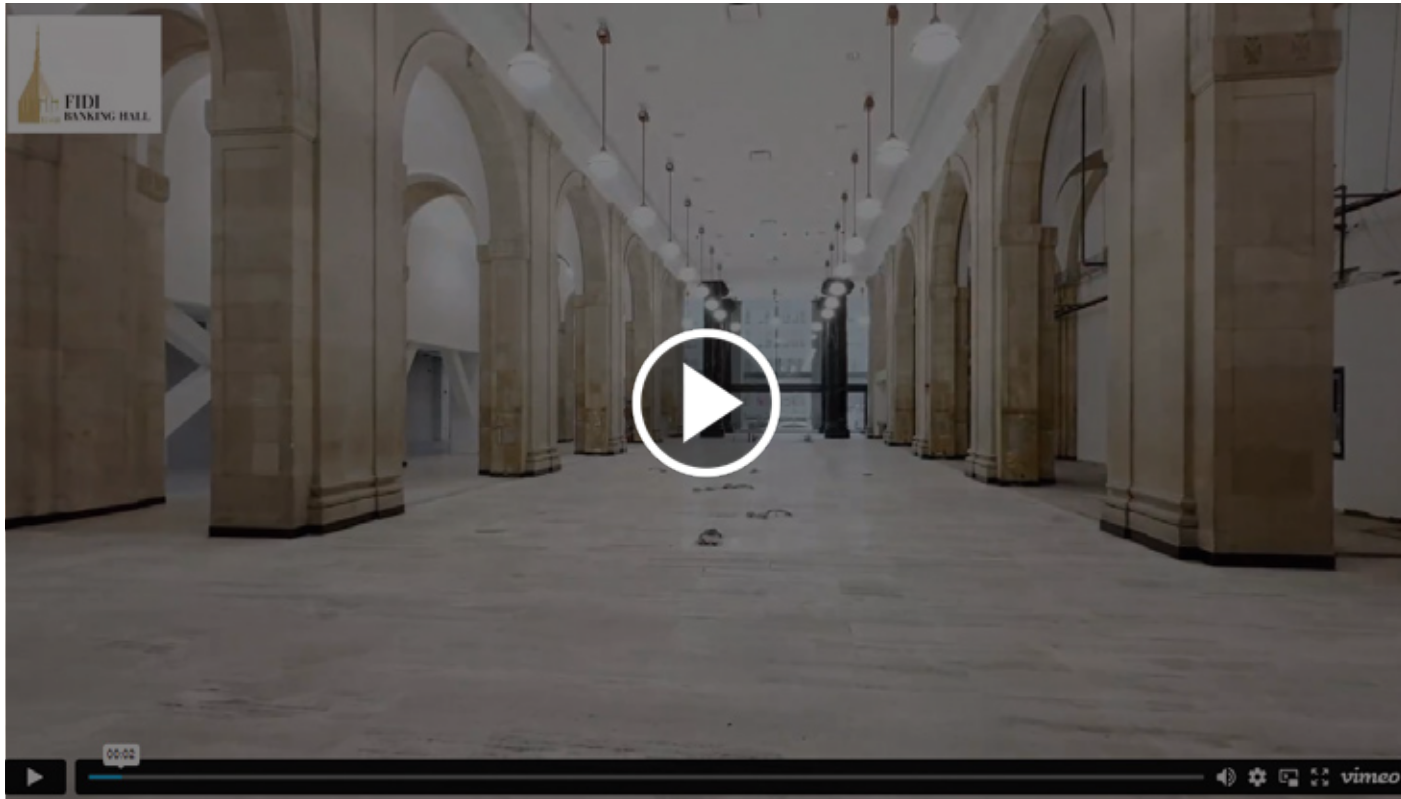

**FIDI**  
BANKING HALL

FIDI BANKING HALL WALKTHROUGH





LAUREN LEUCI  
Event Sales Director  
877.885.0705  
lleuci@mmeink.com